



D220A Keypad Installation Instructions

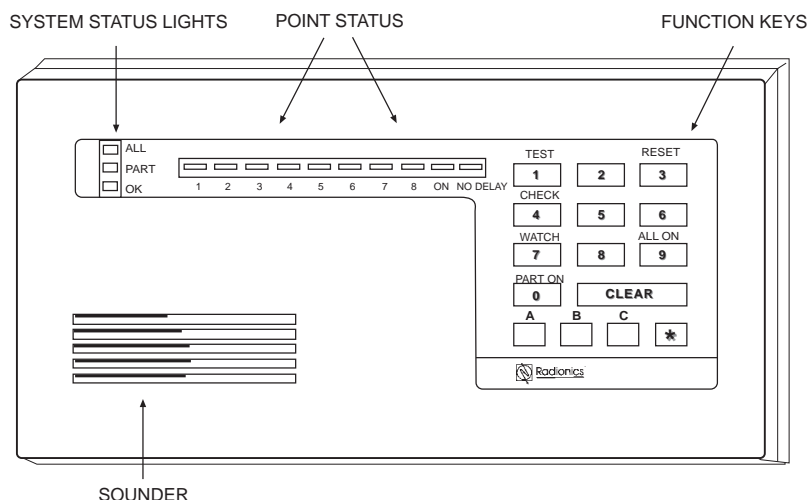

Figure 1: The D220A Keypad

Description

The D220A Keypad is a low-profile, surface-mount, three-wire unit designed for use with the Radionics D2112, D2112E, and D2212 Control/Communicators. The D220A features an illuminated keypad, an LED display, three programmable emergency keys, and a built-in sounder that emits several distinct tones. The D220A is off-white, the D220AW is white.

The control/communicator supplies all power and data requirements for the D220A using a simple three-wire connection.

The Display

The D220A Keypad uses LEDs to display system status. When events occur that affect points, the D220A illuminates the LED that corresponds with the point number.

The Keys

The D220A Keypad has a CLEAR key, three emergency keys labeled A, B, and C, and number keys from 0 to 9. These keys are used to enter functions and personal passcodes into the panel. The  key is not used.

Response Tones

The D220A Keypad uses a sounder to annunciate system conditions. You can disable the sounder if you choose.

Installing the Keypad

Select a Mounting Location - Do not locate the D220A in an area of extreme cold, for example, a non insulated building, refrigerated room, outdoors, or where the temperature can drop below 32F°. Do not mount the keypad in a location exposed to direct sunlight. Direct sunlight makes the display less visible and may also damage the keypad components.

You can mount the D220A on a flat wall, or on the following Radionics accessories:

- D54B Brass Flush Mount Kit
- D54C Chrome Flush Mount Kit
- D55 Command Center Desk Stand
- D56 Command Center Conduit Box

Route the Keypad Wire - Route the wire to the location where you will mount the keypad. See the panel's installation manual for information about the maximum length of keypad wires and wire resistance. Route wires away from electrical, telephone, and other data wiring.

Wire the Connector - The three-wire connector attaches to the keypad wire. Use solder to splice the three-wire connector to the keypad wire. Be sure to insulate all exposed splices with tape so that they do not short to one another.

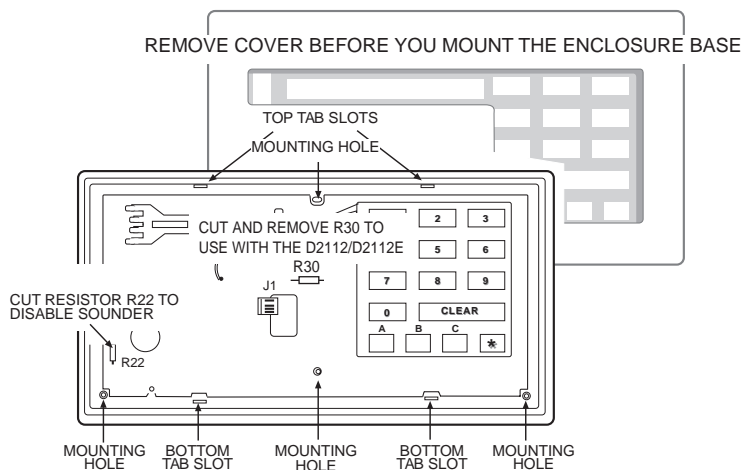

Figure 2: Inside the D220A Keypad

Remove the Front Cover - Remove the front cover from the enclosure base. Use a small flat-bladed screwdriver to gently push the two bottom cover-tabs back. As you push back the tabs, lift the bottom of the cover away from the base, then remove the cover.

To use the D220A with the D2112/D2112E: cut and remove the R30 resistor. See Figure 2.

If disabling sounder, do so before connecting the keypad to the wire: To disable the sounder, cut and remove resistor R22 located in the lower left-hand corner of the board, next to the sounder (see Figure 2).

Fire Points need the trouble sounder: Disabling the sounder by removing R22 stops the D220A from annunciating fire point trouble. If fire points are installed as part of this system, contact the local AHJ to verify code requirements for fire trouble sounders before disabling the D220A sounder.

Enable sounder for UL systems: For UL installations, the sounder on at least one keypad must remain connected.

Connect the Keypad - Plug the color-coded flying lead into connector (J1) on the keypad (see Figure 2).

Mount the Enclosure Base - While pushing excess keypad wire back into the wall or gang box, place the enclosure base on the wall in the desired location. Use a center punch or a pencil to mark the locations of the mounting holes.

You can mount the enclosure base to a recessed single-gang wall box, if desired. Secure the enclosure base to the wall or gang box.

Replace the Front Cover - Align the top two tabs of the enclosure cover with the top two tab slots in the enclosure base. Slide the top of the cover into the base. Gently push the bottom of the cover down on the base until it snaps into place.

Adjust the Keys - Push each key on the keypad towards the top of the enclosure to ensure proper mating with the openings in the top cover.

Connect the Keypad to the Panel - Figure 3 shows a typical installation using one D220A Keypad. Use parallel connections for additional keypads. For more information refer to the panel's installation manual.

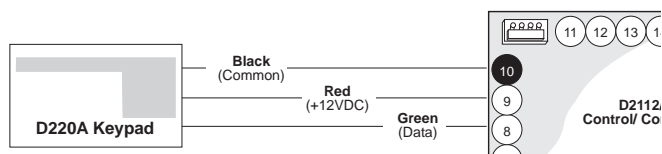

Figure 3: Wiring the D220A to the Panel

D220A Keypad Specifications

Operating Voltage:

Nominal 12 VDC supplied by the control/communicator auxiliary power supply.

Current Requirements:

Maximum: 125mA keypad backlights on, LCD on, LED on, tone on.

Standby: 30mA (backlights off).

Enclosure Dimensions:

Height 4.56", Length 8.15", Depth .816"

Color:

D220A: Off-white

D220AW: White

Operating Temperature:

0 to 50 °C (32 to 122 °F)

Non-condensing Relative Humidity:

5 to 85% at 30 °C (86 °F)

Command Center Wiring:

Three-wire cable supplies data and power.

