

ADEMCO LIMITED WARRANTY

Alarm Device Manufacturing Company, a Division of Pittway Corporation, and its divisions, subsidiaries and affiliates ("Seller"), 165 Eileen Way, Syosset, New York 11791, warrants its products to be in conformance with its own plans and specifications and to be free from defects in materials and workmanship under normal use and service for 18 months from the date stamp control on the product or, for products not having an Ademco date stamp, for 12 months from date of original purchase unless the installation instructions or catalog sets forth a shorter period, in which case the shorter period shall apply. Seller's obligation shall be limited to repairing or replacing, at its option, free of charge for materials or labor, any product which is proved not in compliance with Seller's specifications or proves defective in materials or workmanship under normal use and service. Seller shall have no obligation under this Limited Warranty or otherwise if the product is altered or improperly repaired or serviced by anyone other than Ademco factory service. For warranty service, return product transportation prepaid, to Ademco Factory Service, 165 Eileen Way, Syosset, New York 11791.

THERE ARE NO WARRANTIES, EXPRESS OR IMPLIED, OF MERCHANTABILITY, OR FITNESS FOR A PARTICULAR PURPOSE OR OTHERWISE, WHICH EXTEND BEYOND THE DESCRIPTION ON THE FACE HEREOF. IN NO CASE SHALL SELLER BE LIABLE TO ANYONE FOR ANY CONSEQUENTIAL OR INCIDENTAL DAMAGES FOR BREACH OF THIS OR ANY OTHER WARRANTY, EXPRESS OR IMPLIED, OR UPON ANY OTHER BASIS OF LIABILITY WHATSOEVER, EVEN IF THE LOSS OR DAMAGE IS CAUSED BY THE SELLER'S OWN NEGLIGENCE OR FAULT.

Seller does not represent that the products it sells may not be compromised or circumvented; that the products will prevent any personal injury or property loss by burglary, robbery, fire or otherwise; or that the products will in all cases provide adequate warning or protection. Customer understands that a properly installed and maintained alarm may only reduce the risk of a burglary, robbery, fire or other events occurring without providing an alarm, but it is not insurance or a guarantee that such will not occur or that there will be no personal injury or property loss as a result. CONSEQUENTLY, SELLER SHALL HAVE NO LIABILITY FOR ANY PERSONAL INJURY, PROPERTY DAMAGE OR OTHER LOSS BASED ON A CLAIM THE PRODUCT FAILED TO GIVE WARNING. HOWEVER, IF SELLER IS HELD LIABLE, WHETHER DIRECTLY OR INDIRECTLY, FOR ANY LOSS OR DAMAGE ARISING UNDER THIS LIMITED WARRANTY OR OTHERWISE, REGARDLESS OF CAUSE OR ORIGIN, SELLER'S MAXIMUM LIABILITY SHALL NOT IN ANY CASE EXCEED THE PURCHASE PRICE OF THE PRODUCT, WHICH SHALL BE THE COMPLETE AND EXCLUSIVE REMEDY AGAINST SELLER. This warranty replaces any previous warranties and is the only warranty made by Seller on this product. No increase or alteration, written or verbal, of the obligations of this Limited Warranty is authorized.

® ADEMCO

ALARM DEVICE MANUFACTURING COMPANY

A DIVISION OF PITTWAY CORPORATION

165 Eileen Way, Syosset, New York 11791



No. 5817
MULTI-POINT
UNIVERSAL TRANSMITTER

INSTALLATION INSTRUCTIONS

GENERAL INFORMATION

Each No. 5817 Multi-Point Universal Transmitter may have three contact loops connected to it. Each loop transmits a unique ID code to a 5800 wireless system receiver connected to the system control panel. The Primary Loop has several DIP switch selectable options that determine its connection requirements, response, and transmission characteristics (see DIP switch setting table on next page). The two Auxiliary Loops are closed-circuit, with a nominal response time of 100 mSec. *For UL installations, no contact in any of the loops may be more than 3 feet from the transmitter.*

A built-in cover tamper switch is activated when the cover is removed.

LEARNING THE TRANSMITTER IDs

Each No. 5817 has its own unique identification codes permanently assigned during manufacture. It is not necessary to program the transmitter IDs during installation. Instead, the control unit is required to "learn" the transmitter IDs at some point prior to the transmitter's usage in the alarm system.

The control unit's installation manual contains general information on the "learning" procedure, but the information given herein pertains specifically to the 5817.

1. **Place a 3V battery in the battery holder**, as described later in *BATTERY INSTALLATION/REPLACEMENT* and as shown in Diagram 2. *Observe polarity!*
2. **Make sure that the DIP switch's 4 positions (see Diagram 2) are all OFF.**
3. **Set the system ready for learning the ID code** of one of the 5817's loops (inputs) to be used, as described in the control's instructions. The 5817 should be treated as "RF" (i.e., supervised RF) Type (*mandatory for UL installations*).
4. **Proceed with learning the inputs of the loops to be used**, as described in the control's instructions.

INSTALLATION

Mounting

For proper orientation of the unit in relation to its wall mounting plate and the loop wiring, read all of this section before installing the unit.

The description that follows assumes that the unit will be mounted as shown in the diagrams. The unit may, however, be installed in any direction, as long as the relationship of the unit to its mounting plate is maintained.

Although two holes are provided in the unit that would permit mounting directly to a surface (holes 'A' in Diagram 2), it is recommended that the mounting plate be used, as described below, for ease in removing the unit for servicing should it become necessary.

Before mounting the transmitter permanently, conduct Go/No Go tests (see control's instructions) to verify adequate signal strength and reorient or relocate the transmitter if necessary. When a satisfactory location is found, remove the battery and proceed with installation.

1. **Remove the transmitter's cover** by inserting the flat blade of a small screwdriver into the pry-off slot at the end of the unit farthest from the cover's decorative ribs, and twisting the blade. **Note:** The *open* slot at the other end of the unit *cannot* be used as a cover pry-off.
2. **Disengage the supplied mounting plate from the unit** by inserting the blade of a small screwdriver into the locking tab release window (see Diagram 2) and pressing it against the locking tab (see Diagram 1) while sliding the plate downward along the case back. **Note:** For this application, the alignment guide strip along one edge of the plate serves no function and may be broken away, if desired.

- If **concealed wiring is to be used**, feed the wires through the concealed wiring entry hole at one corner of the plate (*surface wiring is mentioned in Step 5 below*).
- Install the mounting plate**, with its case holding posts pointing up (in this example), in the location selected as described in the control unit's installation instructions. Use the flat head screws supplied.
- If **concealed wiring is to be used**, feed it through the slot in the case back but do not connect to the terminal block yet. **Surface wiring** should enter via the thin "breakout" area provided in the case wall.
- Attach the case back** to the mounting plate by sliding the keyhole slots in the case back down onto the mounting plate's hooks. The locking tab will click as the case back locks in place.
- Set the DIP switch** (after the control has learned the transmitter's input IDs) for the desired primary loop characteristics, as described in the table below.

PRIMARY LOOP OPTIONS TABLE				
SWITCH SETTING	DIP SWITCH POSITION			
	1	2	3	4
ON	REPEATING TRANSMISSION (every 4 sec.) UPON PRIMARY LOOP FAULT Use for high priority alarm, such as fire.	NORMALLY OPEN CIRCUIT PRIMARY LOOP	SLOW PRIMARY LOOP RESPONSE (Approx. 200 mSec Normally Closed Response Time)	3 MINUTE, ALL LOOP TRANSMISSION INHIBIT AFTER RESTORE OF PRIMARY LOOP <div style="border: 1px solid black; padding: 2px; display: inline-block;">See Note c.</div> This affects the Aux. loops as well. Use on frequently used doors, etc. to conserve battery.
OFF	SINGLE TRANSMISSION PER PRIMARY LOOP CHANGE-OF-STATE	NORMALLY CLOSED CIRCUIT PRIMARY LOOP	FAST PRIMARY LOOP RESPONSE (Approx. 5 mSec Normally Closed Response Time)	NO TRANSMISSION INHIBIT

- Notes:**
- While the transmitter is being learned by the control, all DIP switch positions should be OFF.
 - Except in the case of the position 4 ON setting, the Auxiliary loops are not affected by the DIP switch settings.
 - For UL installations with fire zones, the position 4 ON setting must not be used.

Wiring Connections

With the battery still not inserted, connect the loop wiring to the unit's terminals (see Diagram 2).

Note: If a contact loop is not to be used, no connection is needed across its terminals.

BATTERY INSTALLATION/REPLACEMENT

- Remove the transmitter's cover (if not already off) as described in Mounting Step 1.
- Observe correct polarity and insert the battery provided into the battery holder (see Diagram 2). Take care not to bend the antenna.

Note: Replace battery *only* with: Duracell DL123A, Sanyo CR123A, Panasonic CR123A, or Ademco 466.

CAUTION: Risk of fire, explosion and burns. Do not recharge, disassemble, heat above 212°F (100°C) or incinerate. Dispose of used batteries promptly. Keep away from children.

- To replace the cover, engage the hooks along one edge and snap shut.

SPECIFICATIONS

Dimensions 1-9/16"W x 3-1/2"H x 1-3/16"D (40mm x 89mm x 30mm)

Battery 3V Lithium (see BATTERY INSTALLATION/REPLACEMENT).

TO THE INSTALLER

Regular maintenance and inspection (at least annually) by the installer and frequent testing by the user are vital to continuous satisfactory operation of any alarm system.

The installer should assume the responsibility of developing and offering a regular maintenance program to the user, as well as acquainting the user with the proper operation and limitations of the alarm system and its component parts. Recommendations must be included for a specific program of frequent testing (at least weekly) to insure the system's operation at all times.

REFER TO THE INSTALLATION INSTRUCTIONS FOR THE RECEIVER/CONTROL WITH WHICH THIS DEVICE IS USED, FOR DETAILS ON LIMITATIONS OF THE ENTIRE ALARM SYSTEM.

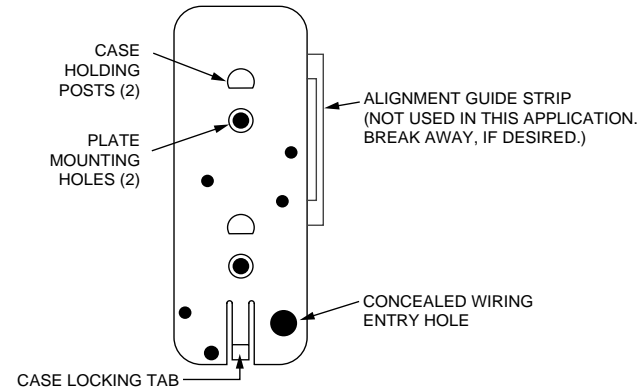

Diagram 1: MOUNTING PLATE

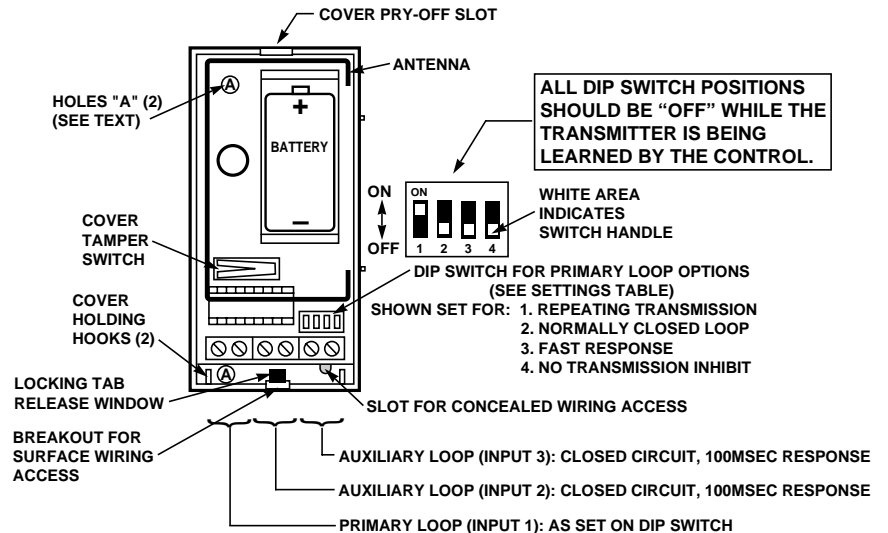

Diagram 2: No. 5817 (SHOWN WITH COVER REMOVED)